

Chain & Drives stocks a range of ASA high quality steel sprockets. Complete with induction hardened teeth, thus improving the sprockets resistance to wear and increasing the sprockets working life.

All sprockets are engineered in accordance with the stringent ISO 9000 standards.

25-1 Sprocket		Teeth	de	dp	Simplex		
					dm	D1	A
		9	18.1	16.59	10	5	15
		10	22.3	20.55	11	5	15
		11	24.3	22.54	14	6	15
		12	26.4	24.33	16	6	15
		13	28.5	26.53	18	6	15
		14	30.5	28.53	20	6	15
		15	32.5	30.55	22	6	15
		16	34.5	32.55	24	8	15
		17	36.5	34.55	26	8	15
		18	38.5	36.56	28	8	15
		19	40.5	38.58	30	8	15
		20	42.5	40.58	32	8	15
		21	44.6	42.60	34	8	15
		22	46.6	44.62	36	8	15
		23	48.6	46.63	38	8	15
		24	50.6	48.64	40	8	15
		25	52.6	50.66	42	8	18
		26	54.6	52.67	44	10	18
		27	54.6	54.69	46	10	18
		28	58.7	56.71	48	10	18
		29	60.7	58.73	48	10	18
		30	62.7	60.75	48	12	18
		35	72.8	70.84	50	12	18
		38	78.8	76.89	50	12	18
		45	93.0	91.03	OA	OA	OA
		50	104		50	12	20
		57	117.2	115.27	OA	OA	OA
		76	155.6	153.66	OA	OA	OA

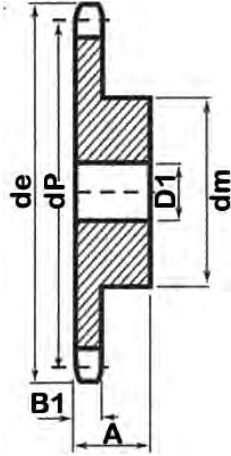
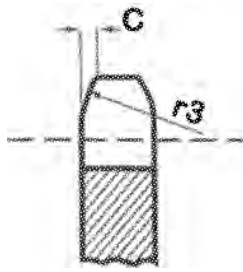

Pinions		mm
Tooth Radius r3		
Radius Width C		
Tooth Width B1		2.9
Chain		mm
Pitch		6.35
Inside		3.18
Roller ø		3.3